

# Roon

Roon 가 . Control, Output, Core

Roon

## Roon Ready

Roon Ready Roon Server, Roon Remote

. Roon Ready

RoonBridge

. hqplayer\_naa

## Roon Ready config

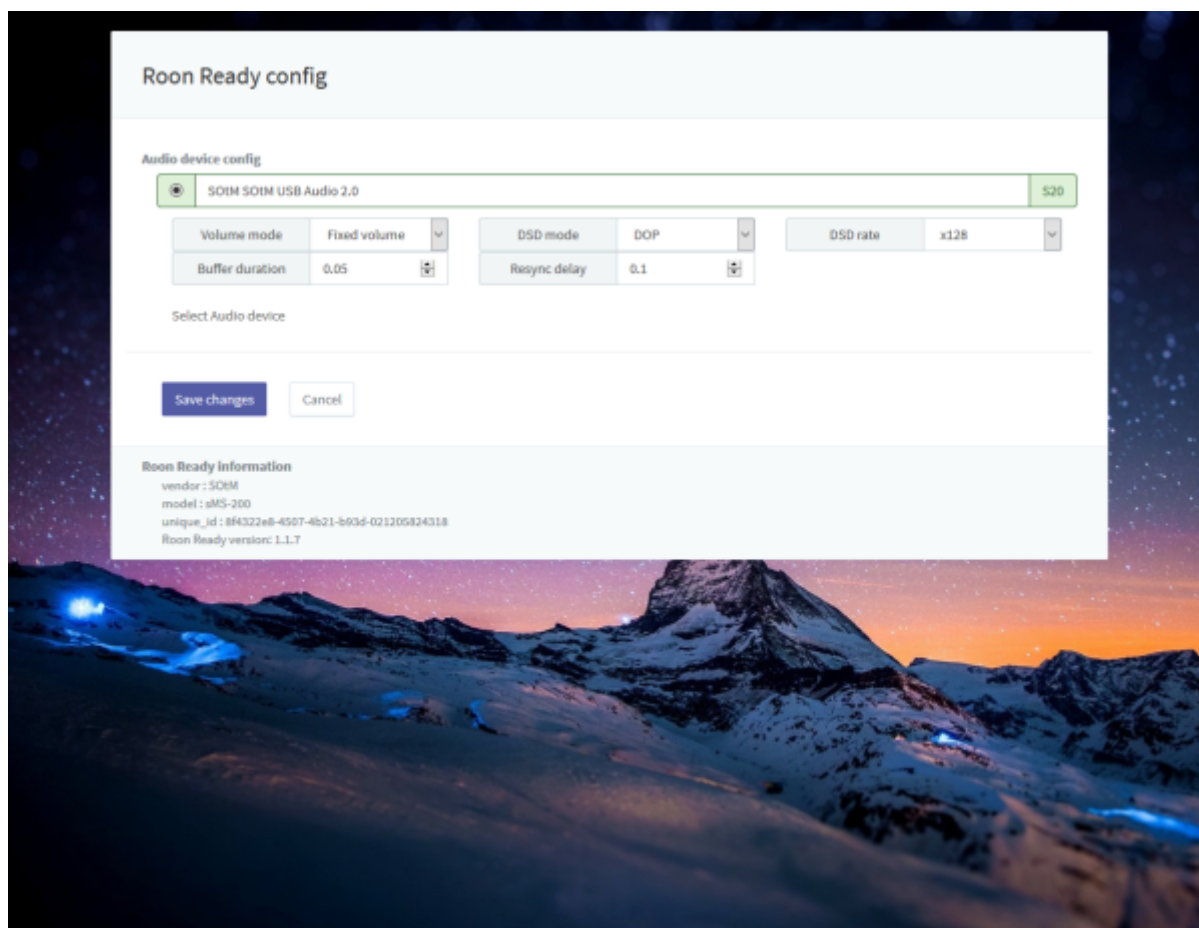

- **Audio device config:** USB DAC
- **Volume mode:** Fixed, Software, Device Controls
- **DSD mode:** DSD NONE, NATIVE, DOP, DCS, NATIVE/DOP, NATIVE/DCS
- **DSD rate:** DSD x64, x128, x256
- **Buffer duration:** 가

- **Resync delay:** 0.1 ~ 0.5                      0.01

# Roon Ready

Roon Ready                      'Active'                      . Roon Desktop                      Setting > Audio                      Roon  
 Ready                      SMS-200                      .  
 . Roon Ready                      'Active'                      . Roon Remote                      Setting > Audio                      Roon  
 Ready                      SMS-200                      .

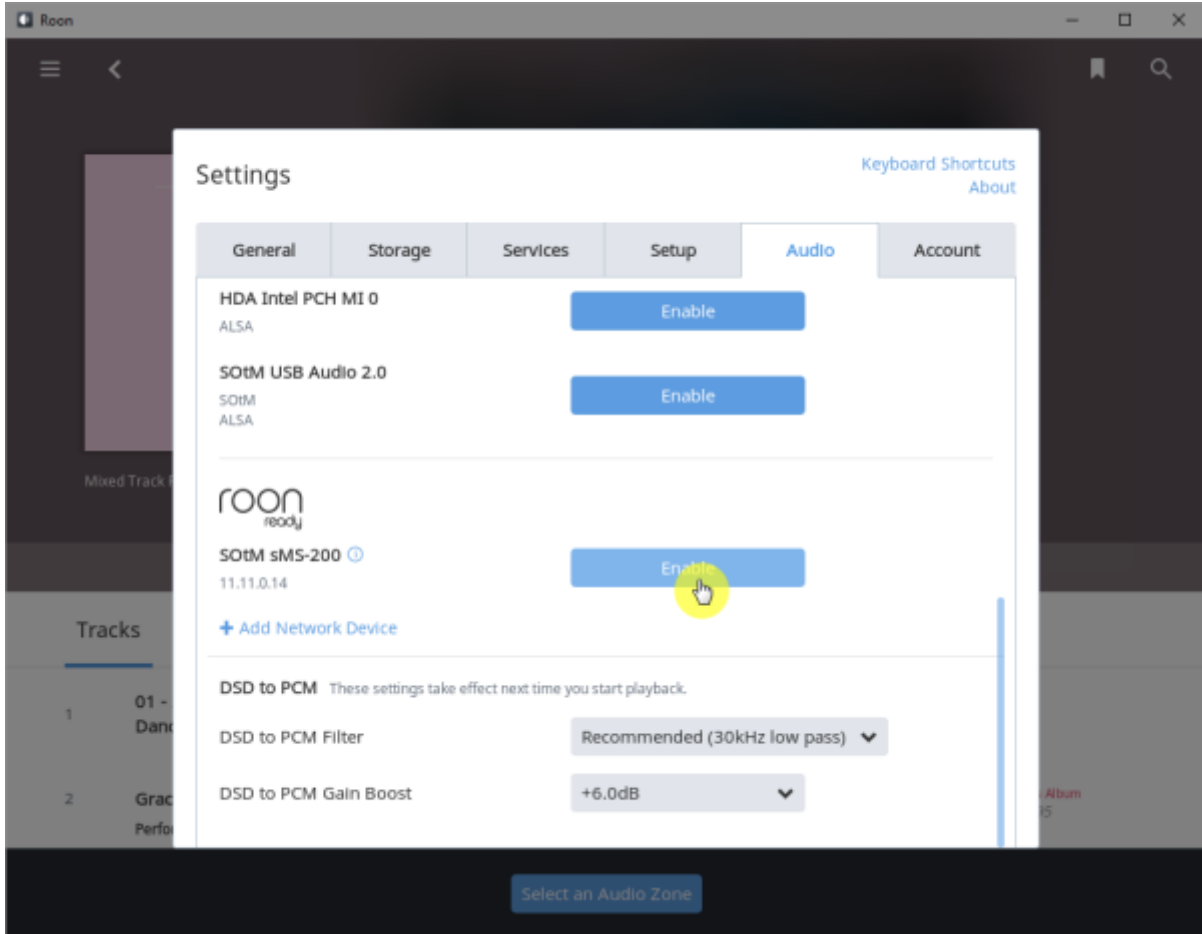

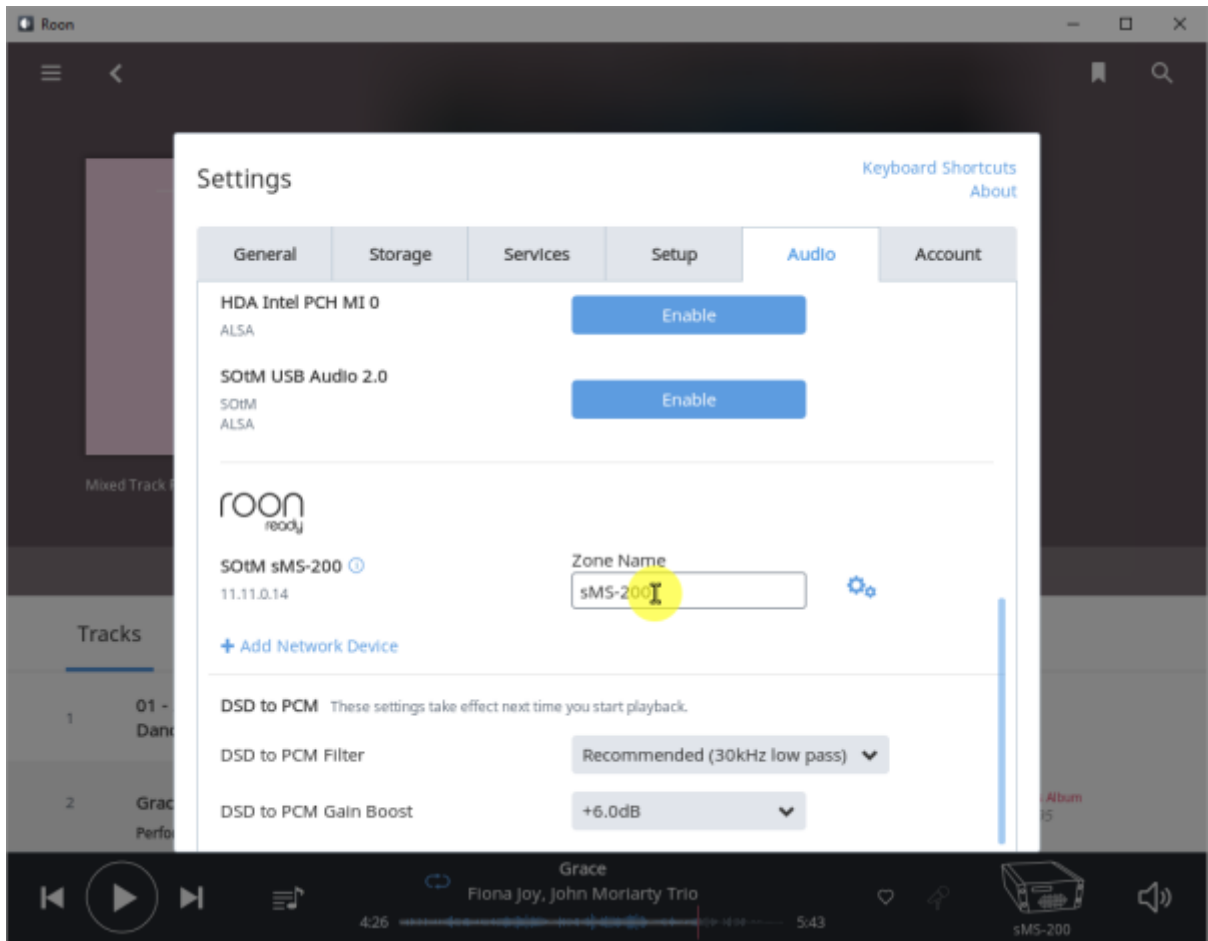

sMS-200 Audio zone



# Roon Server

Roon Server   Roon Core   Roon Output

Roon Remote

[Roonlabs](#)

# Roon Server

Roon Server

'Active'

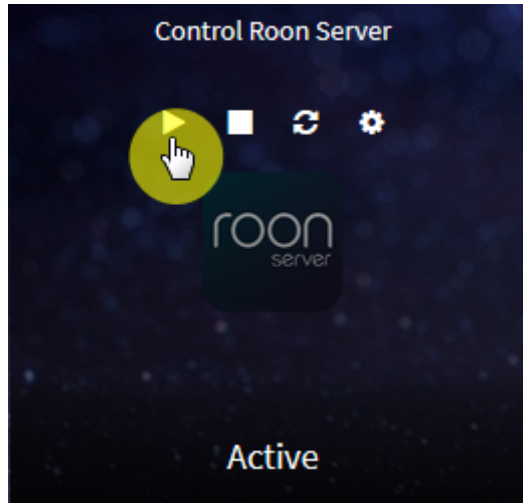

Roon Server 가 'Active'

Roon Desktop

Core

sMS-1000SQ

Core

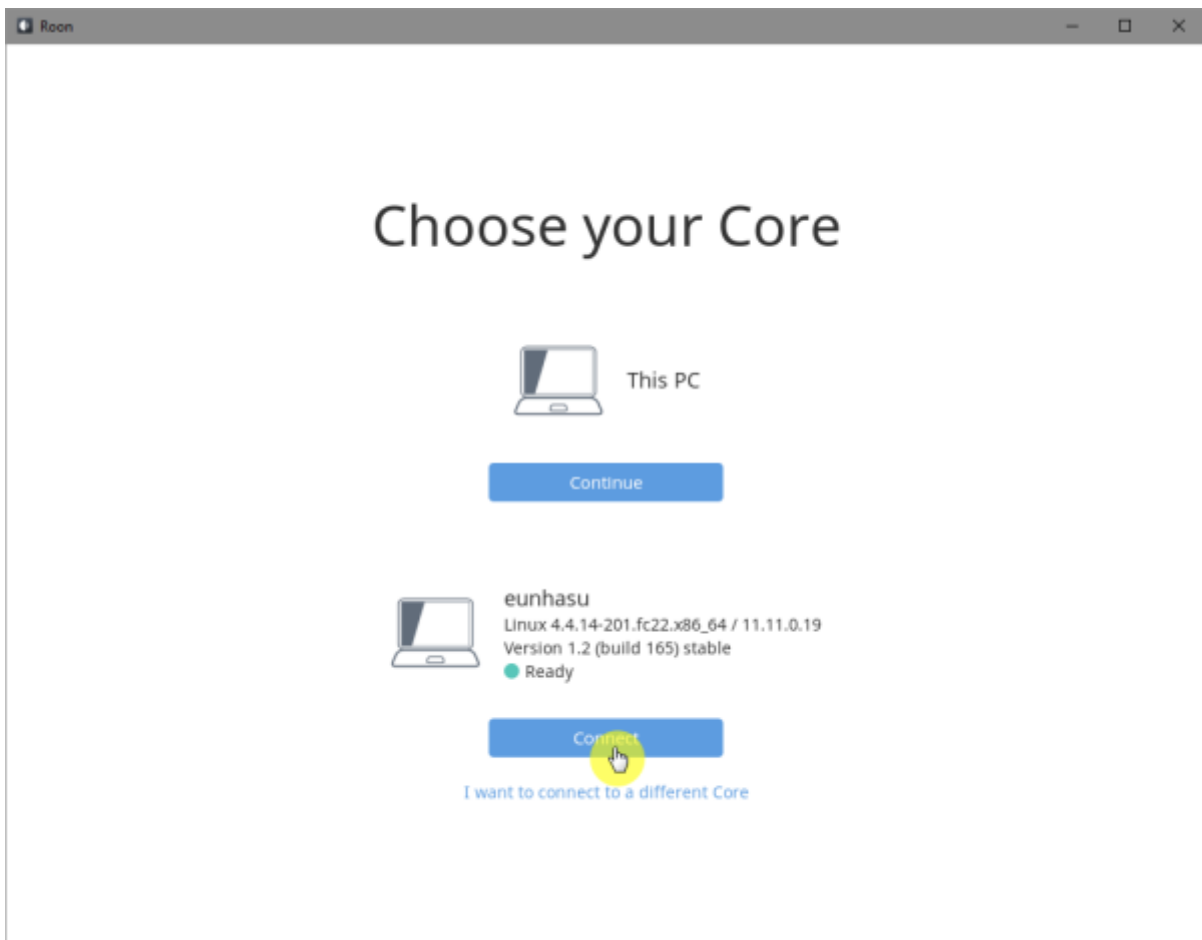

Core

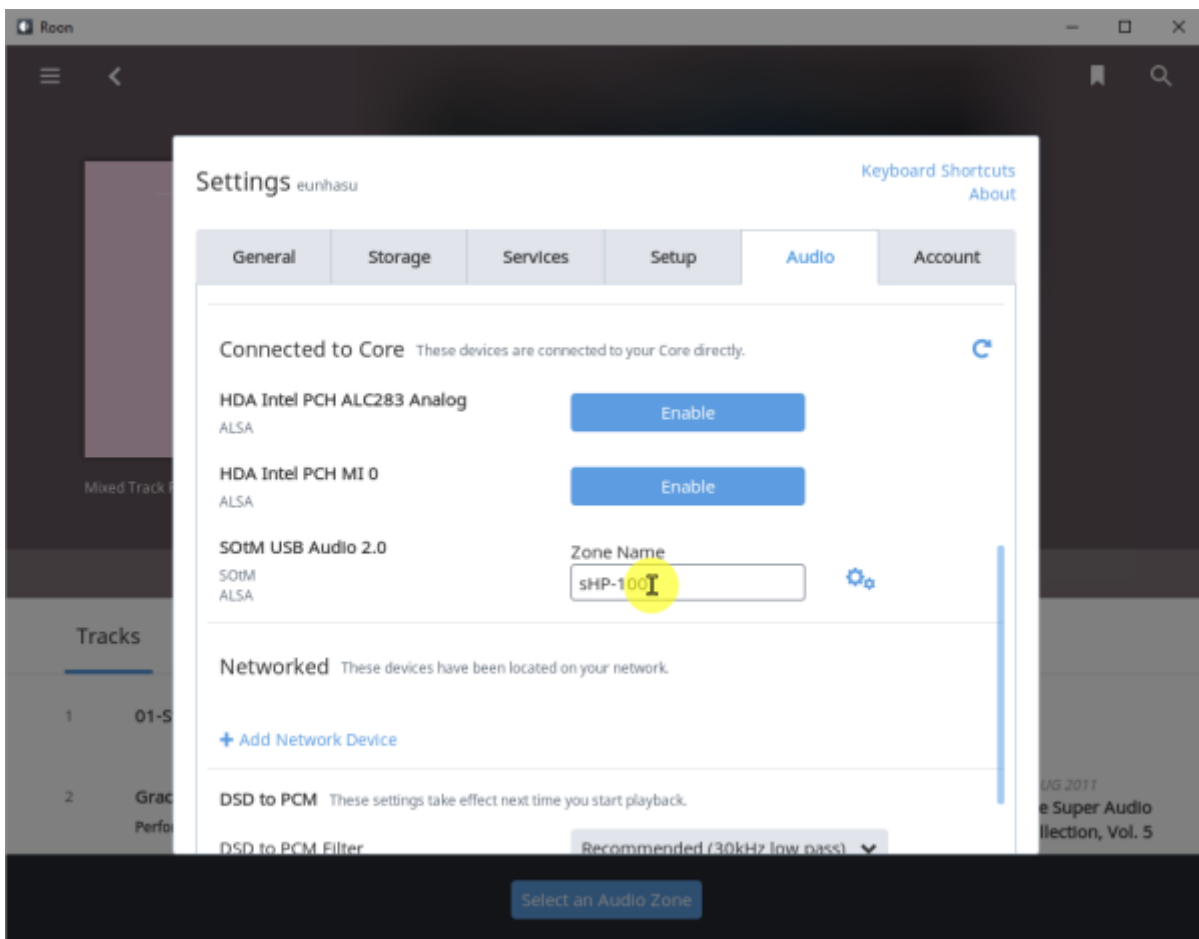
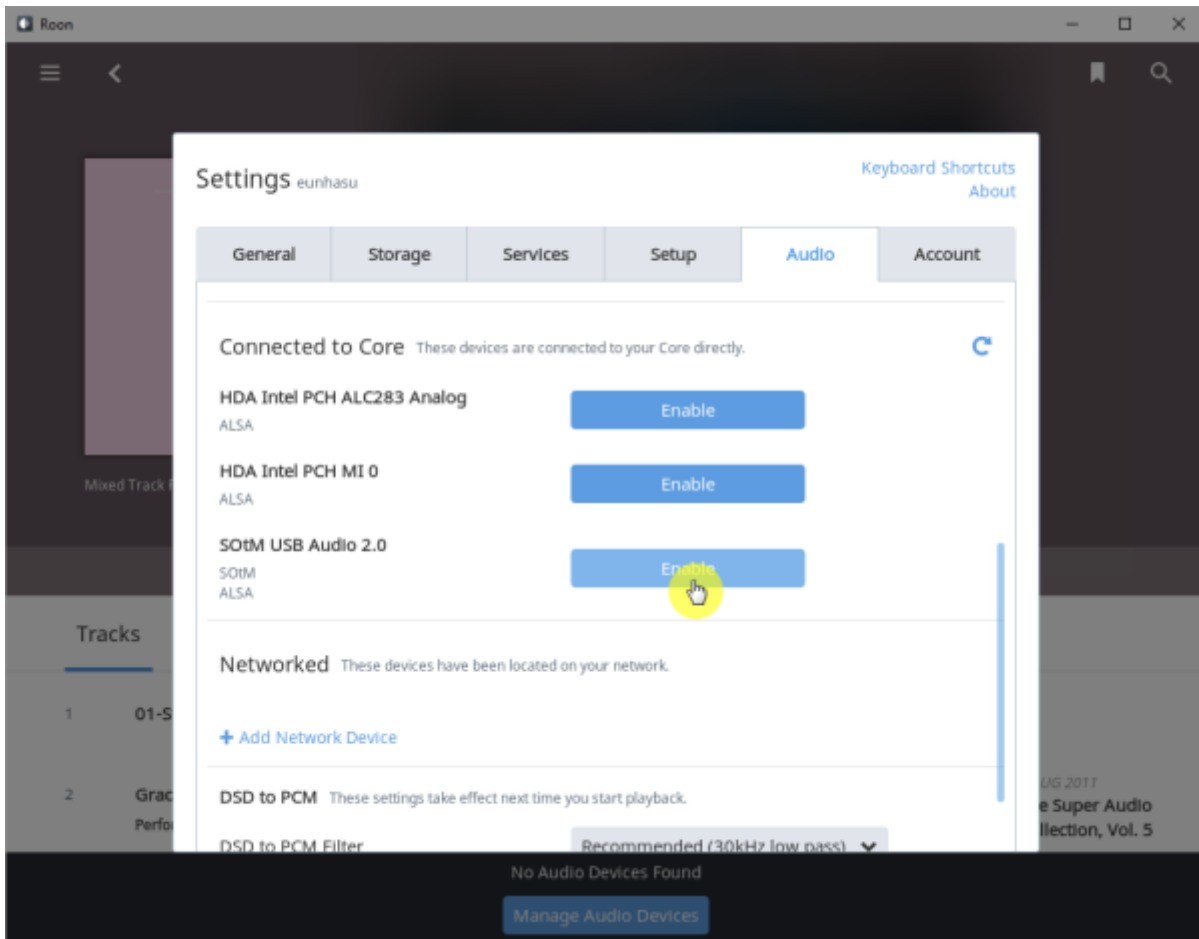

## Audio Zone



: 2017/01/25 00:55

From:  
<https://www.wiki.sotm-audio.com/> - **SOTM docs**

Permanent link:  
<https://www.wiki.sotm-audio.com/doku.php?id=ko:roon&rev=1485323716>

Last update: **2017/01/25 00:55**

