

# Roon

Roon , Control, Output, Core  
Roon

# Roon Ready

Roon Ready Roon Server, Roon Remote

RoonBridge , hqplayer\_naa

. Roon Ready



Roon Ready  
'Active'



. Roon Ready가



- **Audio device config:** USB DAC
- **Volume mode:** Fixed, Software, Device Controls
- **DSD mode:** DSD NONE, NATIVE, DOP, DCS, NATIVE/DOP, NATIVE/DCS
- **DSD rate:** DSD x64, x128, x256
- **Buffer duration:** 가
- **Resync delay:** 0.1 ~ 0.5 0.01

## Roon Ready

Roon Ready 'Active' Roon Desktop Setting > Audio Roon  
 Ready SMS-200



## Audio Zone

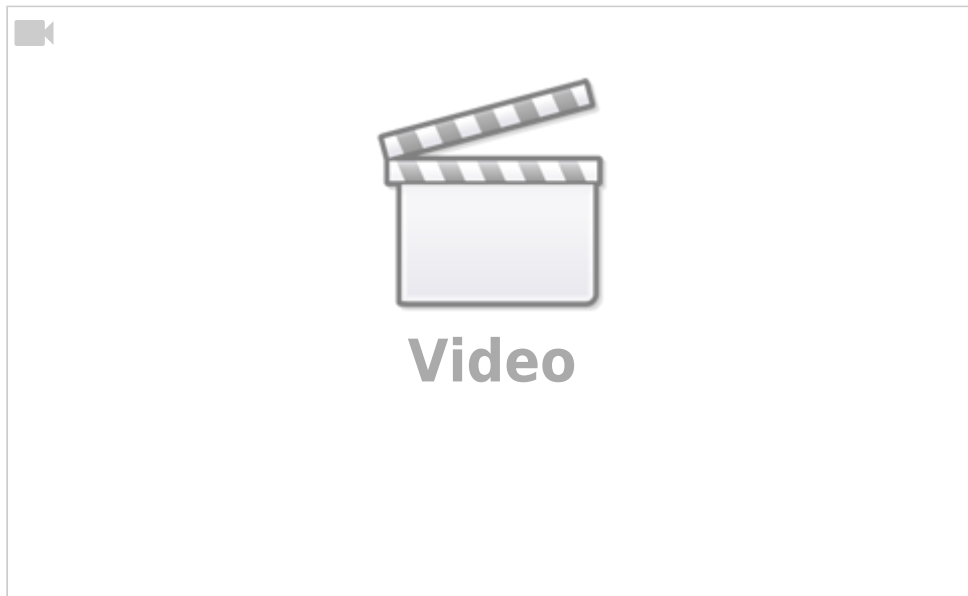
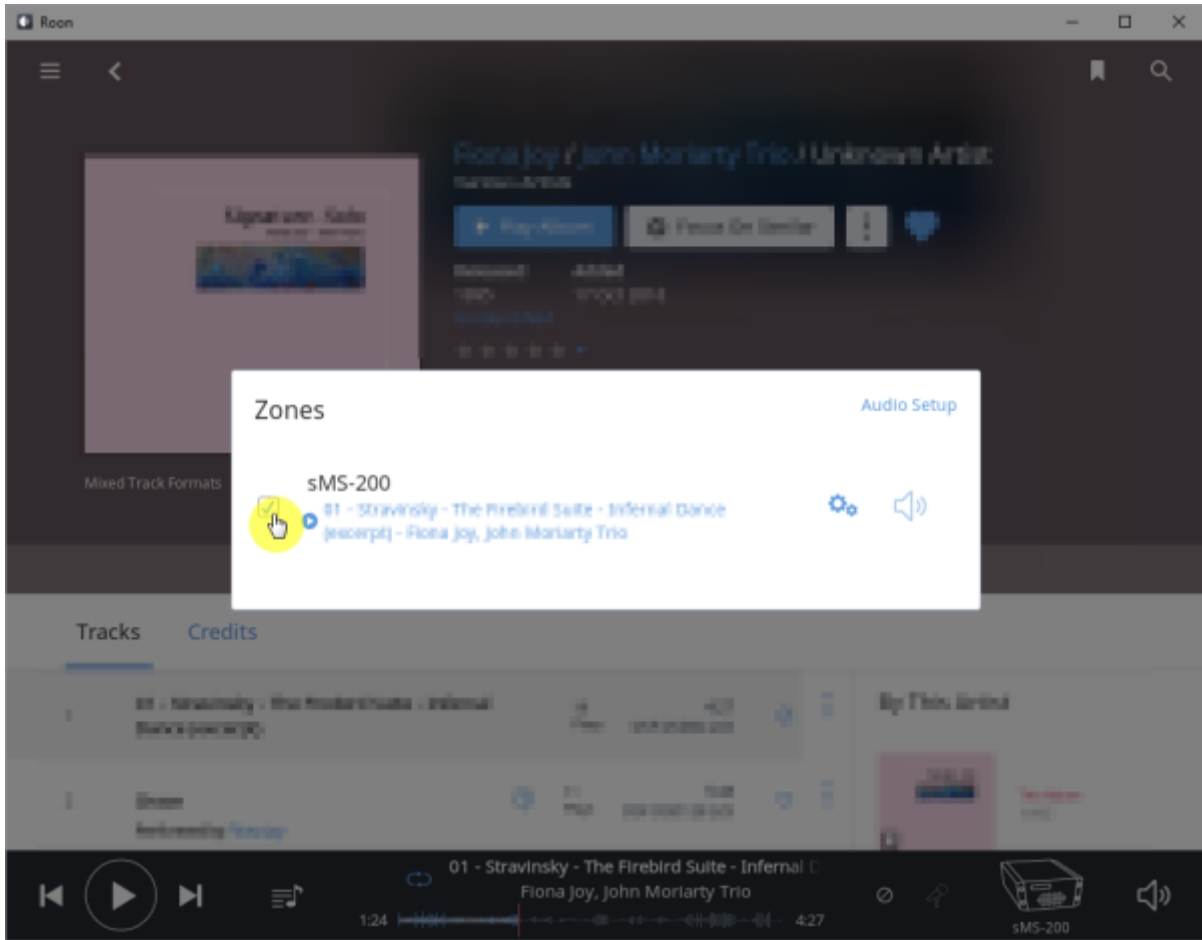

## Roon Server

Roon Server   Roon Core   Roon Output

Roon Remote

. [Roonlabs](https://www.roonlabs.com)

# Roon

## Roos Server

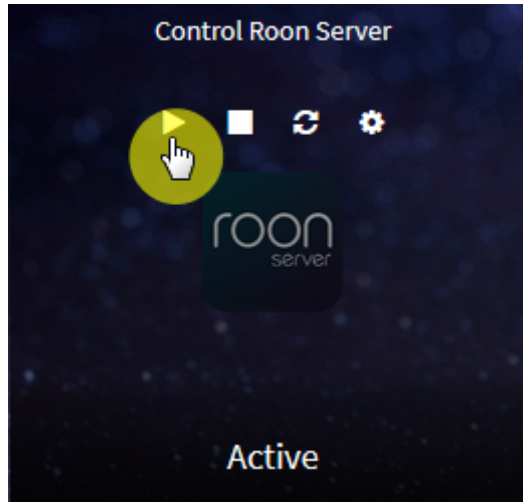

Roos Server 가 (Active)      Roos Desktop    Core    SMS-1000SQ    Core

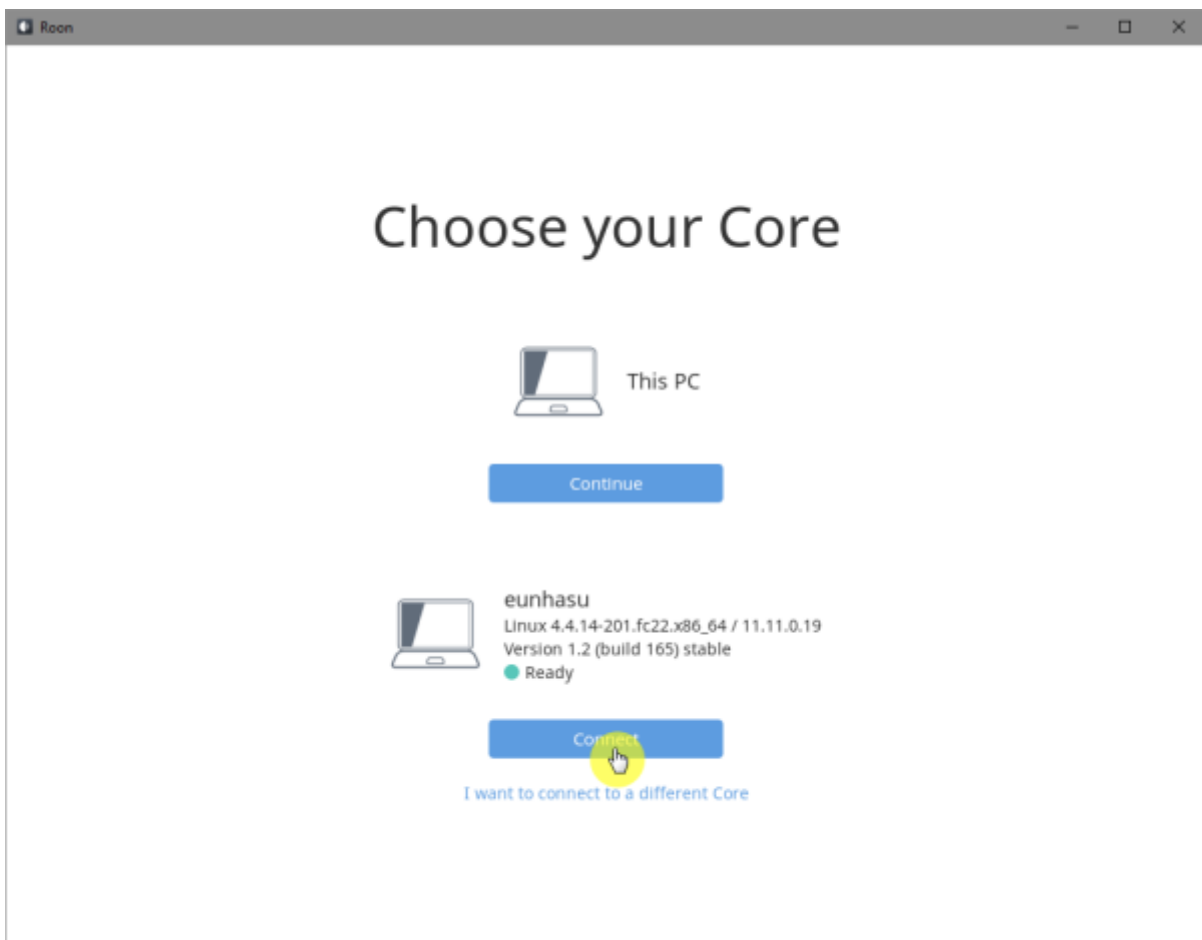

## Core

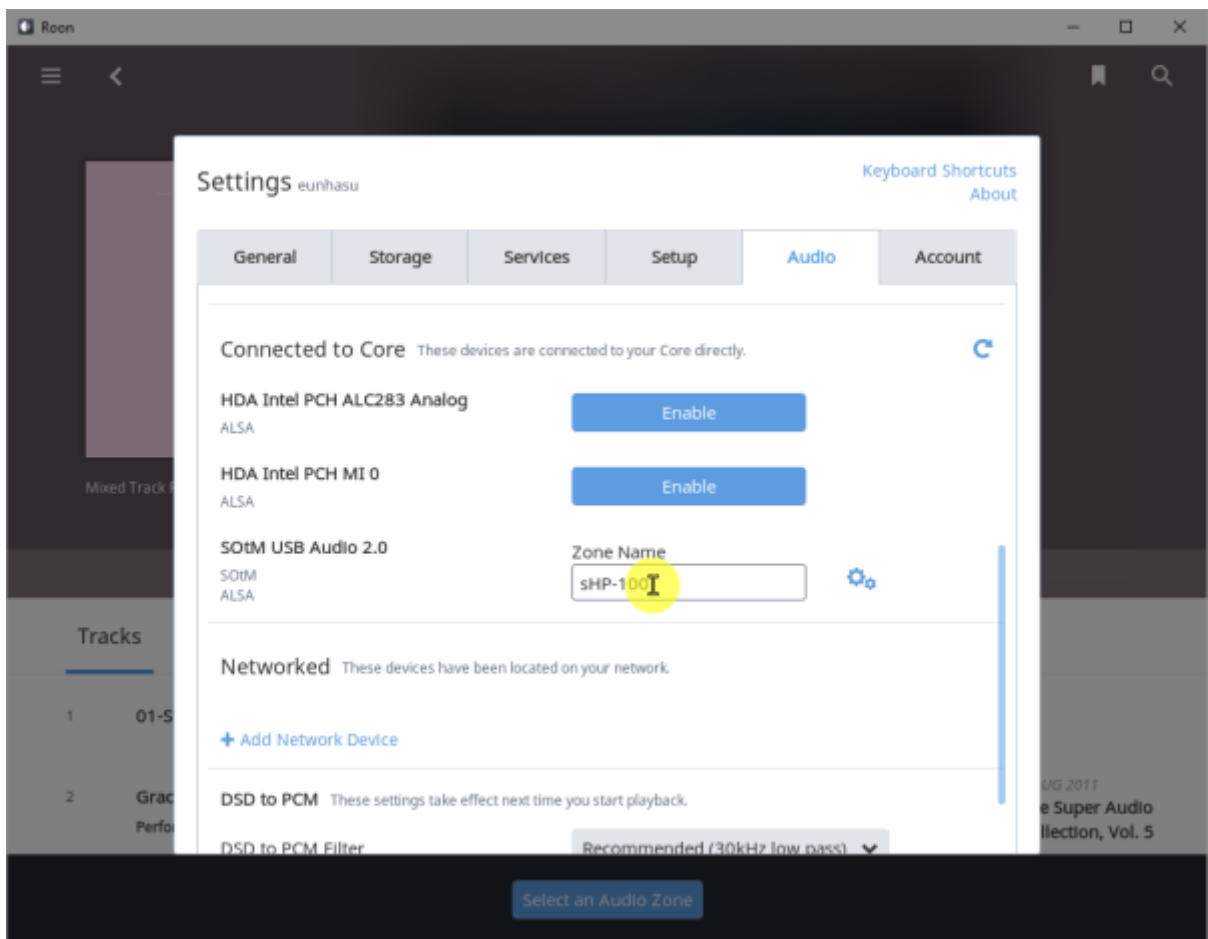
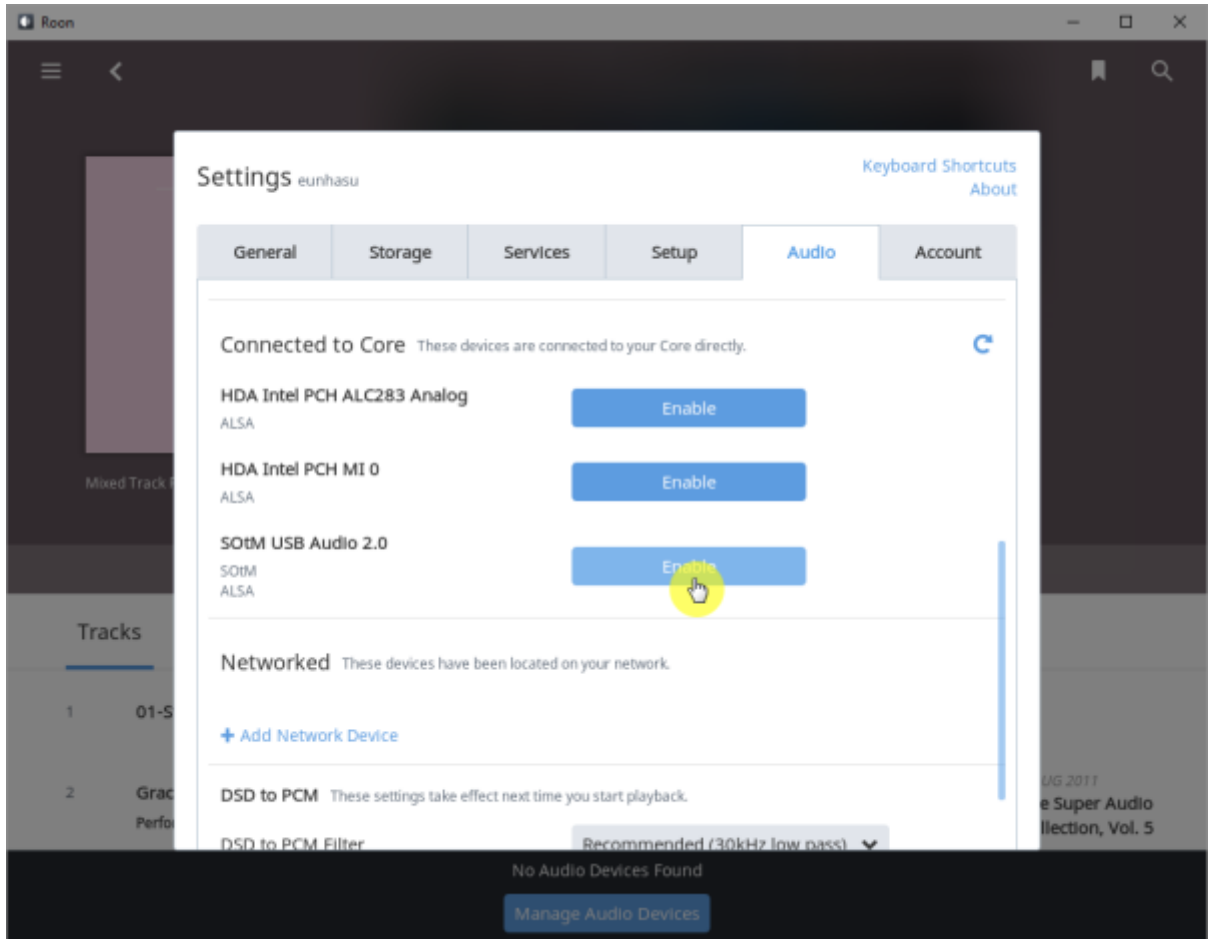

### Audio Zone



: 2017/01/22 22:47

From:  
<https://www.wiki.sotm-audio.com/> - **SOTM docs**

Permanent link:  
<https://www.wiki.sotm-audio.com/doku.php?id=ko:roon&rev=1485143273>

Last update: **2017/01/22 22:47**

